

KPM

Multifunktionale Verbinder

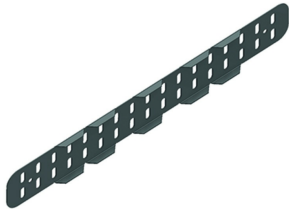

Referenz	Oberfläche	↕ mm	↔ mm	→ ← mm	↔ mm	kg/stk	📦	Einheit
KPM35	SZ	35	10	0,9	450	0,122	10	STK
ZMKPM60	DF	63			450	0,188	10	STK
ZMKPM85	DF	88			450	0,254	10	STK
ZMKPM110	DF	113			450	0,319	10	STK

Min. Anzahl Schrauben und Muttern: 4 Stück.

Legenden Oberfläche

- SZ = Sendzimir
- DF = Defender

Zu befestigen mit:

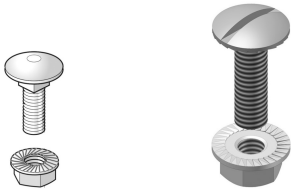

Selbstsichernde
Schraube /
Flanschmutter
VMK

Flachrundkopfschraube
mit Flanschmutter
VM

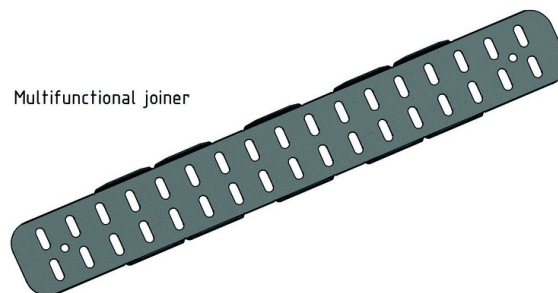

Multifunctional joiner

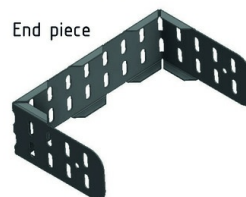

End piece

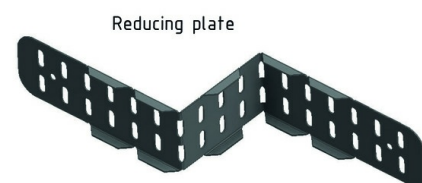

Reducing plate

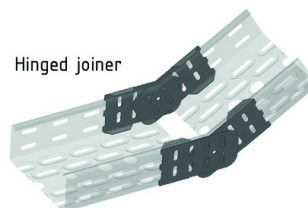

Hinged joiner

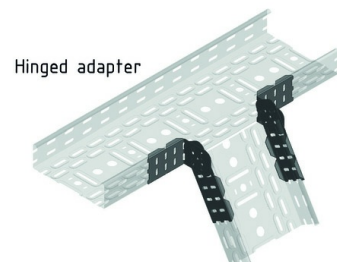

Hinged adapter

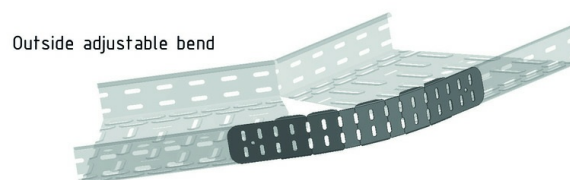

Outside adjustable bend