

# KLMZWBK

## Bracket clamp

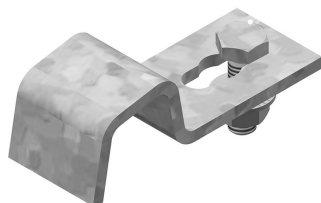

For fixing cable ladder to a wall bracket.  
2 pieces per bracket.

Standard finish		Pre-galvanised							
Optional finish									
Optional finish PE		Coating							
HD	Reference	↕ mm	↔ mm	→  ← mm	↔ mm	kg/stk	📦	Stock	Unit
-	<b>KLMZWBK25</b>	20	25			0,051	20	X	STK
-	<b>KLMZWBK40</b>	20	40			0,125	20	X	STK
-	<b>ZMKLMZWBK25</b>	20	25			0,051	20		STK
-	<b>ZMKLMZWBK40</b>	20	40			0,125	20		STK

To order per full packaging.  
KLMZWBK25: Bolt B6.20 and nuts RM6 included.  
KLMZWBK40: Bolt B8.20 and nuts PNP08 included.

- 25 for cantilevers
- 40 for profiles 41

