

# VFU85

## Wire cable tray for heavy duty

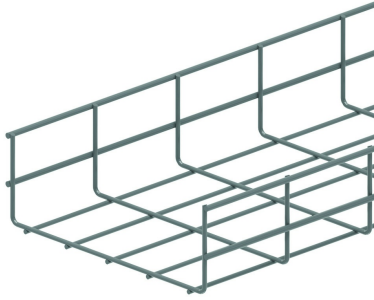

Screen: 50 x 100 mm  
 Wire: Ø 4.50 mm and 5.50 mm

Standard finish	Pre-galvanised
Optional finish	
Optional finish PE	Coating

HD	Reference	↑ mm	↔ mm	→  ← mm	↔ mm	kg/m	📦	Stock	Unit
-	<b>VFU85.150</b>	85	148		3000	1,430	30		M
-	<b>VFU85.250</b>	85	248		3000	1,780	30		M
-	<b>VFU85.350</b>	85	348		3000	2,120	30		M
-	<b>VFU85.450</b>	85	448		3000	2,470	30		M
-	<b>ZAVFU85.150</b>	85	150		3000	1,43	30		M
-	<b>ZAVFU85.250</b>	85	250		3000	1,78	30		M
-	<b>ZAVFU85.350</b>	85	350		3000	2,12	30		M
-	<b>ZAVFU85.450</b>	85	450		3000	2,47	30		M

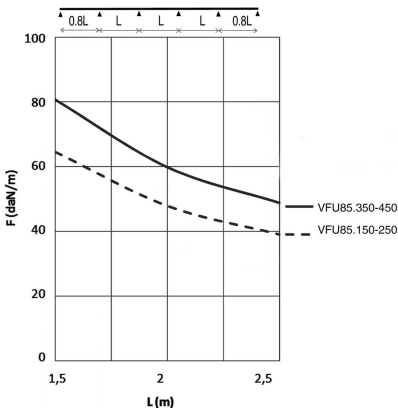

### LOAD DIAGRAM

This diagram illustrates the permissible uniformly distributed loads applied to multiple supports. They comply with IEC 61537 with connection to 1/5 of the span and the end span = 0,8x the span. When the joint is situated in the centre of the span, a reduction of 0,7x the admissible load is to be taken into account.

F = max. admissible load (daN/m)  
 L = support distance (m)  
 Max. deflection (m) = L/100

Usable inside height: outside height - 9mm  
 Usable inside width: outside width - 17mm

### Fix with:

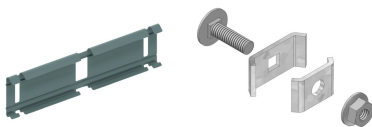

Snap-on joiner for VFU(L)  
 KPVF

Joining clamp VFK