

# VFU110

## Wire cable tray for heavy duty

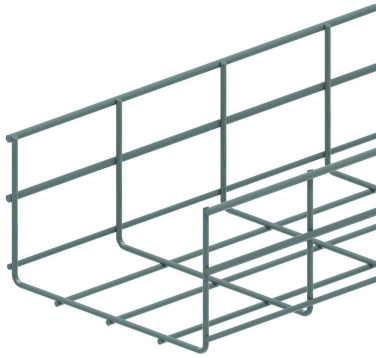

Screen: 50 x 100 mm  
Wire: Ø 4.50 mm and 5.50 mm

Reference	Finish	↑ mm	↔ mm	→  ← mm	↔ mm	kg/m	📦	Unit
<b>VFU110.200</b>	SZ	110	199		3000	1,780	30	M
<b>VFU110.300</b>	SZ	110	299		3000	2,120	30	M
<b>VFU110.400</b>	SZ	110	399		3000	2,470	30	M
<b>ZAVFU110.200</b>	DF	110	200		3000	1,780	30	M
<b>ZAVFU110.300</b>	DF	110	300		3000	2,120	30	M
<b>ZAVFU110.400</b>	DF	110	400		3000	2,470	30	M

### LOAD DIAGRAM

This diagram illustrates the permissible uniformly distributed loads applied to multiple supports. They comply with IEC 61537 with connection to 1/5 of the span and the end span = 0,8x the span. When the joint is situated in the centre of the span, a reduction of 0,7x the admissible load is to be taken into account.

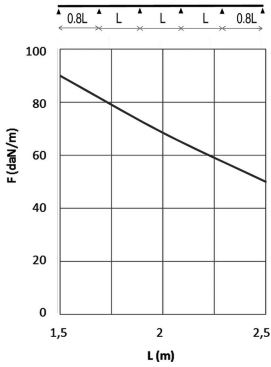

F = max. admissible load (daN/m)  
L = support distance (m)  
Max. deflection (m) = L/100

Usable inside height: outside height - 9mm  
Usable inside width: outside width - 17mm

### Legend finish

- SZ = Sendzimir
- DF = Defender

### Fix with:

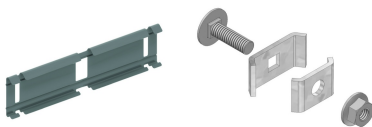

Snap-on joiner for VFU(L) KPVF  
Joining clamp VFK